

# Land Registry Current title plan

Title number **NK446463**  
Ordnance Survey map reference **TM1280NE**  
Scale **1:2500**  
Administrative area **Norfolk : South Norfolk**

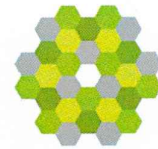

© Crown copyright and database rights 2015 Ordnance Survey 100026316. You are not permitted to copy, sub-license, distribute or sell any of this data to third parties in any form.

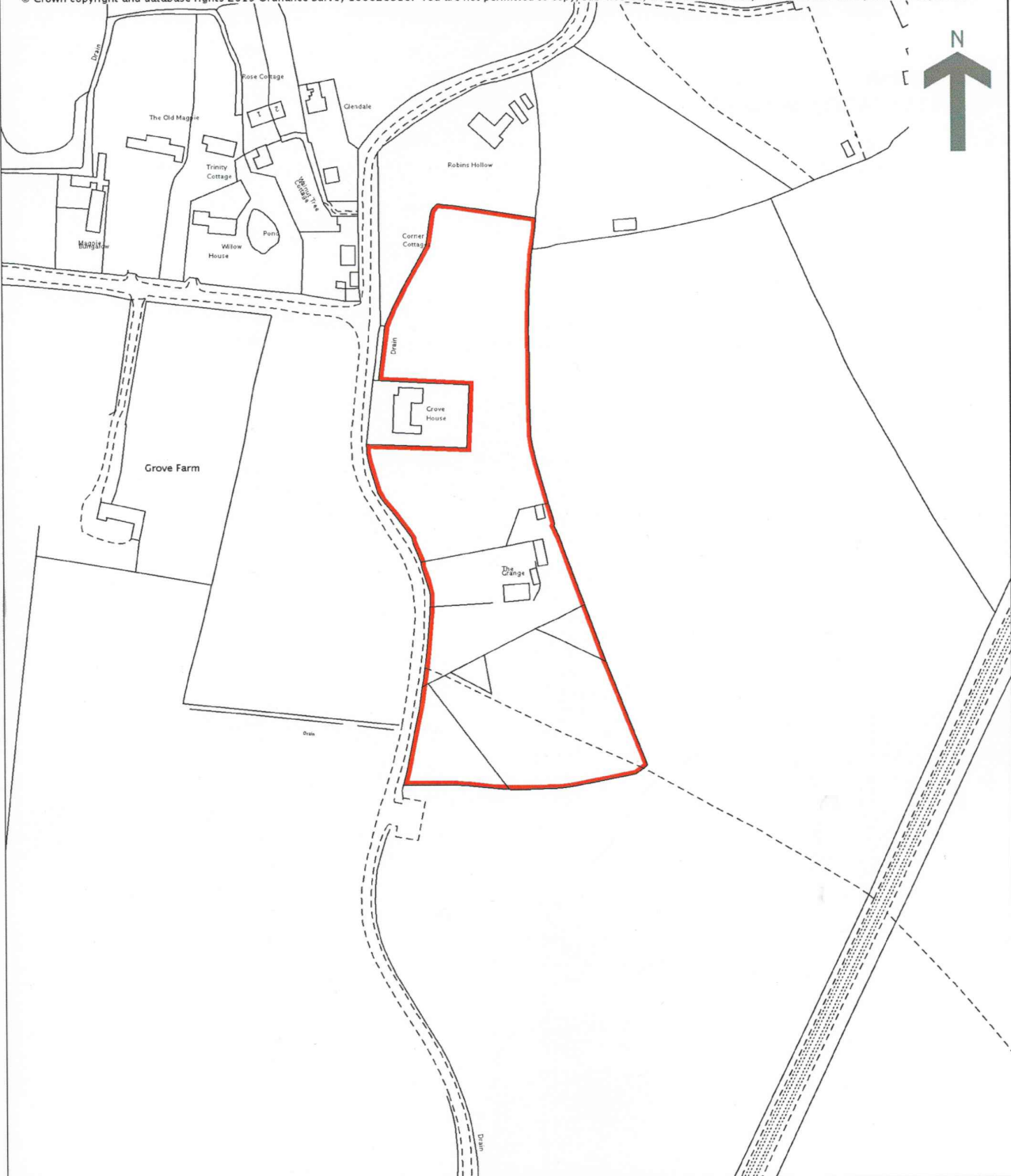

This is a print of the view of the title plan obtained from Land Registry showing the state of the title plan on 03 February 2017 at 08:42:25. This title plan shows the general position, not the exact line, of the boundaries. It may be subject to distortions in scale. Measurements scaled from this plan may not match measurements between the same points on the ground.

This title is dealt with by Land Registry, Kingston upon Hull Office.

**Diss**



MAP 007

Local Plan - Site Specific Allocations & Policies DPD - (Please see this map in conjunction with the policy text for this settlement)

*The Change  
← west  
Diss IP22 SSS*

- Development Boundary
- Parish Boundary
- Conservation area
- Housing Allocation
- Employment Allocation
- Mixed Use Allocation
- Open Space Amenity
- Primary Shopping Area
- Town or Village Centre
- Diss Heritage Triangle
- Important Local Open Space
- Local Nature Reserve
- County Wildlife Sites
- River Valleys
- Corridors of Movement

Scale at A3  
1:10,000

Corridors of Movement

MM51

MM24

MM51

MM52

MM26

<b>1a. Contact Details</b>	
Title	
First Name	
Last Name	
Job Title (where relevant)	
Organisation (where relevant)	
Address	
Post Code	
Telephone Number	
Email Address	

<b>1b. I am...</b>	
Owner of the site	Parish/Town Council
Developer	Community Group
Land Agent	Local Resident
Planning Consultant	Registered Social Landlord
Other (please specify):	

<b>1c. Client/Landowner Details</b> (if different from question 1a)	
Title	
First Name	
Last Name	
Job Title (where relevant)	
Organisation (where relevant)	
Address	
Post Code	
Telephone Number	
Email Address	

<b>2. Site Details</b>	
Site location / address and post code  (please include as an attachment to this response form a location plan of the site on an scaled OS base with the boundaries of the site clearly shown)	
Grid reference (if known)	
Site area (hectares)	

<b>Site Ownership</b>		
<b>3a. I (or my client)....</b>		
Is the sole owner of the site	Is a part owner of the site	Do/Does not own (or hold any legal interest in) the site whatsoever
<b>3b. Please provide the name, address and contact details of the site's landowner(s) and attach copies of all relevant title plans and deeds (if available).</b>		
<b>3c. If the site is in multiple landownerships do all landowners support your proposal for the site?</b>	Yes	No
<b>3d. If you answered no to the above question please provide details of why not all of the sites owners support your proposals for the site.</b>		

<b>Current and Historic Land Uses</b>		
<b>4a. Current Land Use</b> (Please describe the site's current land use e.g. agriculture, employment, unused/vacant etc.)		
<b>4b. Has the site been previously developed?</b>	Yes	No

**4c. Describe any previous uses of the site.** (please provide details of any relevant historic planning applications, including application numbers if known)

--

**Proposed Future Uses**

**5a. Please provide a short description of the development or land use you proposed** (if you are proposing a site to be designated as local green space please go directly to question 6)

--

**5b. Which of the following use or uses are you proposing?**

Market Housing	Business & offices	Recreation & Leisure
Affordable Housing	General industrial	Community Use
Residential Care Home	Storage & distribution	Public Open Space
Gypsy & Traveller Pitches	Tourism	Other (Please Specify)

**5c. Please provide further details of your proposal, including details on number of houses and proposed floorspace of commercial buildings etc.**

--

**5d. Please describe any benefits to the Local Area that the development of the site could provide.**

--



<b>Local Green Space</b>
--------------------------

If you are proposed a site to be designated as Local Green Space please complete the following questions. These questions do not need to be completed if you are not proposing a site as Local Green Space. Please consult the guidance notes for an explanation of Local Green Space Designations.
---

<b>6a. Which community would the site serve and how would the designation of the site benefit that community.</b>
---

--

<b>6b. Please describe why you consider the site to be of particular local significance e.g. recreational value, tranquillity or richness in wildlife.</b>
--

--

<b>Site Features and Constraints</b>
--------------------------------------

Are there any features of the site or limitations that may constrain development on this site (please give details)?
--

<b>7a. Site Access:</b> Is there a current means of access to the site from the public highway, does this access need to be improved before development can take place and are there any public rights of way that cross or adjoin the site?
--

--

<b>7b. Topography:</b> Are there any slopes or significant changes of in levels that could affect the development of the site?
--

--

<b>7c. Ground Conditions:</b> Are ground conditions on the site stable? Are there potential ground contamination issues?
--

--

<b>7d. Flood Risk:</b> Is the site liable to river, ground water or surface water flooding and if so what is the nature, source and frequency of the flooding?
--

--

<b>7e. Legal Issues:</b> Is there land in third party ownership, or access rights, which must be acquired to develop the site, do any restrictive covenants exist, are there any existing tenancies?
--

--

**7f. Environmental Issues:** Is the site located next to a watercourse or mature woodland, are there any significant trees or hedgerows crossing or bordering the site are there any known features of ecological or geological importance on or adjacent to the site?

--

**7g. Heritage Issues:** Are there any listed buildings, Conservation Areas, Historic Parklands or Schedules Monuments on the site or nearby? If so, how might the site's development affect them?

--

**7h. Neighbouring Uses:** What are the neighbouring uses and will either the proposed use or neighbouring uses have any implications?

--

**7i. Existing uses and Buildings:** are there any existing buildings or uses that need to be relocated before the site can be developed.

--

**7j. Other:** (please specify):

--

**Utilities**

**8a. Which of the following are likely to be readily available to service the site and enable its development? Please provide details where possible.**

	Yes	No	Unsure
Mains water supply			
Mains sewerage			
Electricity supply			
Gas supply			
Public highway			
Broadband internet			



Other (please specify):	
<b>8b. Please provide any further information on the utilities available on the site:</b>	

<b>Availability</b>	
<b>9a. Please indicate when the site could be made available for the land use or development proposed.</b>	
Immediately	
1 to 5 years (by April 2021)	
5 - 10 years (between April 2021 and 2026)	
10 – 15 years (between April 2026 and 2031)	
15 - 20 years (between April 2031 and 2036)	
<b>9b. Please give reasons for the answer given above.</b>	

<b>Market Interest</b>		
<b>10. Please choose the most appropriate category below to indicate what level of market interest there is/has been in the site. Please include relevant dates in the comments section.</b>		
	Yes	Comments
Site is owned by a developer/promoter		
Site is under option to a developer/promoter		
Enquiries received		

Site is being marketed		
None		
Not known		

<b>Delivery</b>	
<b>11a. Please indicate when you anticipate the proposed development could be begun.</b>	
Up to 5 years (by April 2021)	
5 - 10 years (between April 2021 and 2026)	
10 – 15 years (between April 2026 and 2031)	
15 - 20 years (between April 2031 and 2036)	
<b>11b. Once started, how many years do you think it would take to complete the proposed development (if known)?</b>	

<b>Viability</b>			
<b>12a. You acknowledge that there are likely to be policy requirements and Community Infrastructure Levy (CIL) costs to be met which will be in addition to the other development costs of the site (depending on the type and scale of land use proposed). These requirements are likely to include but are not limited to: Affordable Housing; Sports Pitches &amp; Children's Play Space and Community Infrastructure Levy</b>			
	Yes	No	Unsure
<b>12b. Do you know if there are there any abnormal costs that could affect the viability of the site e.g. infrastructure, demolition or ground conditions?</b>			
<b>12c. If there are abnormal costs associated with the site please provide details:</b>			
<b>12d. Do you consider that the site is currently viable for its proposed use taking into account any and all current planning policy and CIL considerations and other abnormal development costs associated with the site?</b>			

12e. Please attach any viability assessment or development appraisal you have undertaken for the site, or any other evidence you consider helps demonstrate the viability of the site.

**Other Relevant Information**

13. Please use the space below to for additional information or further explanations on any of the topics covered in this form

<b>Check List</b>	
Your Details	
Site Details (including site location plan)	
Site Ownership	
Current and Historic Land Uses	
Proposed Future Uses	
Local Green Space (Only to be completed for proposed Local Green Space Designations)	
Site Features and Constraints	
Utilities	
Availability	
Market Interest	
Delivery	
Viability	
Other Relevant Information	
Declaration	

<b>14. Declaration</b>	
<p>I understand that:</p> <p><b>Data Protection and Freedom of Information</b></p> <p>The Data Controller of this information under the Data Protection Act 1998 will be Norfolk County Council, which will hold the data on behalf of Broadland District Council, Norwich City Council and South Norfolk District Council. The purposes of collecting this data are:</p> <ul style="list-style-type: none"> <li>• To assist in the preparation of the Greater Norwich Local Plan</li> <li>• To contact you, if necessary, regarding the answers given in your form.</li> <li>• To evaluate the development potential of the submitted site for the uses proposed within the form.</li> </ul> <p><b>Disclaimer</b></p> <p>The responses received as part of the Greater Norwich Local Plan "Call for Sites" will be published and made available for public viewing. By submitting this form you are consenting to the details about you and your individual sites being stored by Norfolk County Council, and the details being published for consultation purposes. Any information you consider to be confidential is clearly marked in the submitted response form and you have confirmed with the Council(s) in advance that such information can be kept confidential as instructed in the Greater Norwich Local Plan Call for Sites Response Form Guidance Notes.</p> <p>I agree that the details within this form can be held by Norfolk County Council and that those details can be shared with Broadland District Council, Norwich City Council and South Norfolk District Council for the purposes specified in this declaration.</p>	
Name	Date

