

Notes:

AV	Air Valve	FH	Fire Hydrant	SP	Sign Post
BB	Bottom Bank	FP	Footpath	STAY	Stay
BH	Bore Hole	GV	Gully Grate	SV	Sluice Valve
BL	Li Bolard	IC	Inspection Cover	TAC	Tactile Paving
BOL	Bolard	IL	Invert Level	TB	Top Bank
BIN	Bin	KO	Kerb Outlet	TBOX	Telephone Box
BS	Bus Stop	LP	Lamp Post	TL	Traffic Light
Bushes	Bush	MP	Marker Post	TOK	Top Of Kerb
BT	BT Box	NB	Name Board	TP	Telegraph Pole
CAB	Cabinet	PW	Partition Wall	TRK	Track
CHNL	Channel	PB	Post Box	TS	Traffic Sign MH
CL	Centreline	PM	Parking Meter	VENT	Vent
CONC	Concrete	PO	Post	W	Water Cover
COL	Column	RE	Rodding Eye	WL	White Line
CS	Chop Bottom	RF	Ridge Level	WO	Wash Out
DCHNL	Drainage Channel	RS	Road Sign	YL	Yellow Line
Door	Door	SET3	Granite Setts		
EEB	Electric MH Cover	SF	Safety Fence		
EP	Electric Pole				
ER	Earth Road				
ET	EP+Transformer				
Feeder	Feeder Pillar				

Features

FCB 1.20	Close Boarded	CS	Control Station
W 1.20	Wall	COL	Column
H 1.20	Hedge	XXX	Floor to Ceiling Height
OHL	Overhead Line	XXX FC	Floor to False Ceiling Height

Services

0.2250	Storm Sewers	FW 100	Pipe position and alignment is indicative only
0.3750	Storm Sewers	200 150	Pipe position and alignment is indicative only

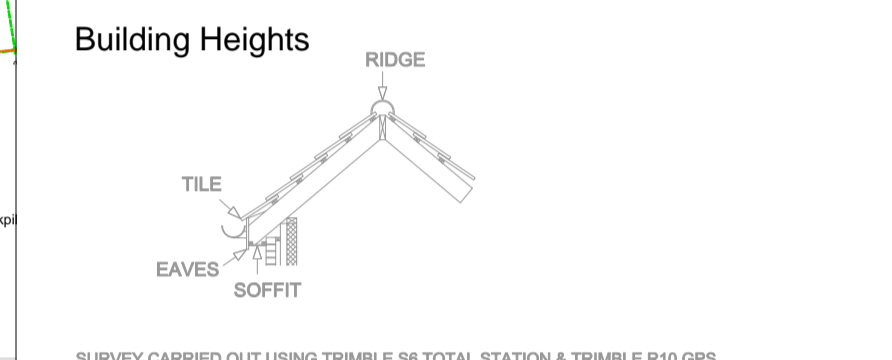

SURVEY CARRIED OUT USING TRIMBLE S8 TOTAL STATION & TRIMBLE R10 GPS. ALL SURVEY DATA TO ORDNANCE SURVEY NATIONAL GRID (OSTN15). ALL DIMENSIONS ARE IN METRES UNLESS OTHERWISE STATED. ANY CRITICAL DIMENSIONS AND MEASUREMENTS SHOULD BE BASED ON THE ORIGINAL DIGITAL DATA AND CONFIRMED WITH BB SURVEYS LTD. ANY ERRORS SHOULD BE NOTIFIED TO BB SURVEYS LTD.

NO ATTEMPT HAS BEEN MADE TO ENTER ANY CONFINED SPACES ON THIS SITE. WE HAVE MEASURED INVERT DEPTHS, ESTIMATED PIPE SIZES AND SHOWN THE DIRECTION OF FLOW ONLY WHERE DRAIN RUNS ARE ACTIVE AT THE TIME OF SURVEY. INSPECTION COVERS WHICH WE WERE UNABLE TO LIFT BY MANUAL METHODS ARE DENOTED AS MH (D/L). WE DO NOT QUOTE FOR THE USE OF HYDRAULIC LIFTING EQUIPMENT.

DRAINAGE RUNS BETWEEN INSPECTION COVERS HAVE NOT BEEN INVESTIGATED. ANY SHOWN ARE ESTIMATED AND NOT CONFIRMED. ALL DRAINAGE RUNS SHOULD BE PROVED BY DYE TRACING AND IF NECESSARY BY RADIO DETECTION METHODS PRIOR TO ANY DESIGN WORK. ALL PIPE SIZES AND CONNECTIONS SHOULD ALSO BE CONFIRMED WITH YOUR LOCAL DRAINAGE AUTHORITY PRIOR TO ANY DESIGN WORK.

THERE MAY BE INSPECTION COVERS ON SITE WHICH WERE NOT VISIBLE AT THE TIME OF SURVEY. THEY MAY HAVE BEEN BURIED OR COVERED BY VEGETATION. YOU SHOULD CONSULT YOUR LOCAL DRAINAGE AUTHORITY OR COMMISSION A CCTV DRAINAGE SURVEY TO ENSURE THAT YOU LOCATE ANY MISSING COVERS OR DRAINAGE RUNS.

REV	Date	Created By	Comments
-	14.02.17	BB	First Issue

Scale at A1	Project Number
1:250	2219-413



**1 Chestnut Place, Cringleford  
 Norwich, Norfolk NR4 7BD**  
 t: 01603 507917  
 m: 07786 388175  
 e: barry@bbsurveys.co.uk

Client  
**Scott Properties  
 Graham McCormick**

Project  
**Land at Marriots Way,  
 Taverham, Norwich**

Title  
**Existing Ground Level Survey  
 Sheet 13**

Note: The Property Of This Drawing Is Vested In BB SURVEYS LTD And Must Not Be Copied Or Reproduced In Any Way Without Their Written Consent.  
 File Path: D:\work\scott\scott\scott\2219-413\SU02 - Scott Properties - Land at Marriots Way, Taverham.dwg  
 Plot Date: 21 February 2017 Plot Style: BB Surveys Std.ctb Saved By: Administrator on 21 February 2017