

**BBS- BB- EGL- SU- 40**  
 Originator Initials Detail Type Number Revision

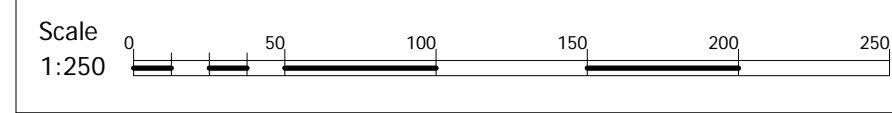
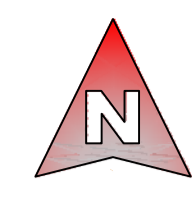

**Notes:**

AV Air Valve	FH Fire Hydrant	SP Sign Post
BB Bottom Bank	FP Footpath	STAY Stay
BH Bore Hole	GV Gully Grate	SV Sluice Valve
BL Li Bolard	GV Gas Valve	TAC Tactile Paving
BOL Bolard	Hedge	TB Top Bank
BIN Bin	IC Inspection Cover	TBOX Telephone Box
BS Bus Stop	IL Invert Level	TL Traffic Light
Bushes Bush	KO Kerb Outlet	TOK Top Of Kerb
BT BT Box	LP Lamp Post	TP Telegraph Pole
CAB Cabinet	MH Manhole	TRK Track
CHNL Channel	MP Marker Post	TS Traffic Sign MH
CL Centreline	NB Name Board	VENT Vent
CONC Concrete	PW Partition Wall	W Water Cover
COL Column	PB Post Box	WL White Line
DBI Drop Bottom	PM Parking Meter	WO Wash Out
DCHNL Drainage Channel	PO Post	YL Yellow Line
Door Door	RE Rodding Eye	
EEB Electric MH Cover	Ridge	
EP Electric Pole	RP Reflector Post	
ER Earth Road	RS Road Sign	
ET EP+Transformer	SETTS Granite Sets	
Feeder Feeder Pillar	SF Safety Fence	

FCB Close Boarded	Control Station
FCL Chain Link	Column
FHD Hoarding	XXX Floor to Ceiling Height
FHR Horse Fence	XXX FC Floor to False Ceiling Height
FPL Palisade	
FPR Post & Rail	
FPW Post & Wire	
RAIL Railings	

**Features**

FCB 1.25	Average root line shown.
W 1.25	Indicative position of cables.
Hedge 1.25	
OHL	

**Services**

0.2250	0.2000	0.2000	0.2000	Pipe position and alignment is indicative only.
0.2250	0.2000	0.2000	0.2000	

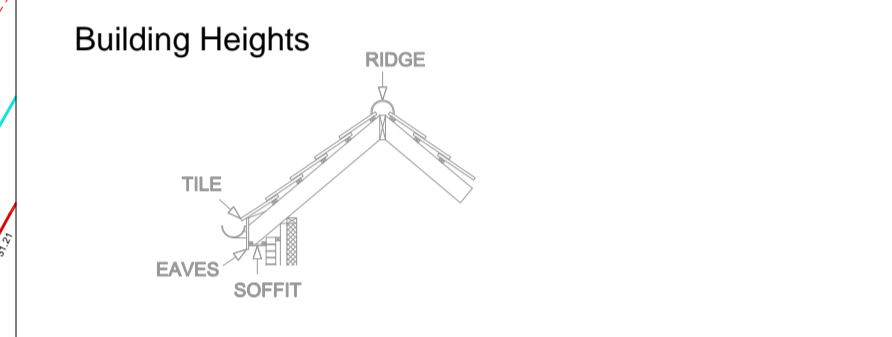

SURVEY CARRIED OUT USING TRIMBLE S8 TOTAL STATION & TRIMBLE R10 GPS. ALL SURVEY DATA TO ORDNANCE SURVEY NATIONAL GRID (OSTN15). ALL DIMENSIONS ARE IN METRES UNLESS OTHERWISE STATED. ANY CRITICAL DIMENSIONS AND MEASUREMENTS SHOULD BE BASED ON THE ORIGINAL DIGITAL DATA AND CONFIRMED WITH BB SURVEYS LTD. ANY ERRORS SHOULD BE NOTIFIED TO BB SURVEYS LTD.

NO ATTEMPT HAS BEEN MADE TO ENTER ANY CONFINED SPACES ON THIS SITE. WE HAVE MEASURED INVERT DEPTHS, ESTIMATED PIPE SIZES AND SHOWN THE DIRECTION OF FLOW ONLY WHERE DRAIN RUNS ARE ACTIVE AT THE TIME OF SURVEY. INSPECTION POINTS WHICH WE WERE UNABLE TO LIFT BY MANUAL METHODS ARE DENOTED AS MH (D/L). WE DO NOT QUOTE FOR THE USE OF HYDRAULIC LIFTING EQUIPMENT.

DRAINAGE RUNS BETWEEN INSPECTION COVERS HAVE NOT BEEN INVESTIGATED. ANY SHOWN ARE ESTIMATED AND NOT CONFIRMED. ALL DRAINAGE RUNS SHOULD BE PROBED BY DYE TRACING AND, IF NECESSARY BY RADIO DETECTION METHODS PRIOR TO ANY DESIGN WORK. ALL PIPE SIZES AND CONNECTIONS SHOULD ALSO BE CONFIRMED WITH YOUR LOCAL DRAINAGE AUTHORITY PRIOR TO ANY DESIGN WORK.

THERE MAY BE INSPECTION COVERS ON SITE WHICH WERE NOT VISIBLE AT THE TIME OF SURVEY. THEY MAY HAVE BEEN BURIED OR COVERED BY VEGETATION. YOU SHOULD CONSULT YOUR LOCAL DRAINAGE AUTHORITY OR COMMISSION A CCTV DRAINAGE SURVEY TO ENSURE THAT YOU LOCATE ANY MISSING COVERS OR DRAINAGE RUNS.

REV	Date	Created By	Project Number	Comments
-	14.02.17	BB	2219-413	First Issue

Scale at A1: **1:250**

Drawing Status:

- Existing Topographic Survey
- As Built Survey
- For Information



**1 Chestnut Place, Cringleford  
 Norwich, Norfolk NR4 7BD**  
 t: 01603 507917  
 m: 07786 388175  
 e: barry@bbsurveys.co.uk

Client: **Scott Properties  
 Graham McCormick**

Project: **Land at Marriots Way,  
 Taverham, Norwich**

Title: **Existing Ground Level Survey  
 Sheet 39**

**BBS- BB- EGL- SU- 40**  
 Originator Initials Detail Type Number Revision

