

100
Millimetres
10
0

DO NOT SCALE

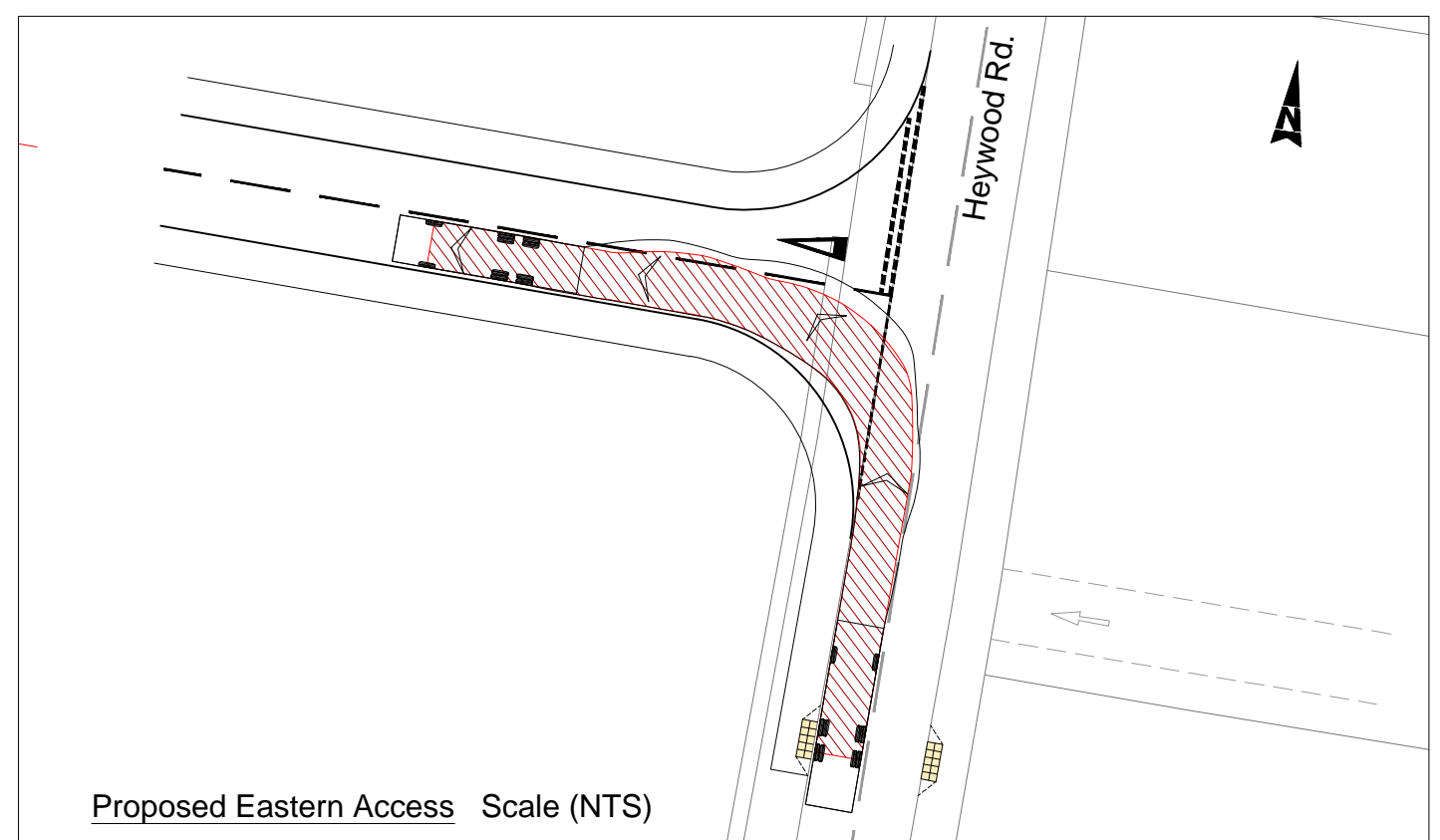
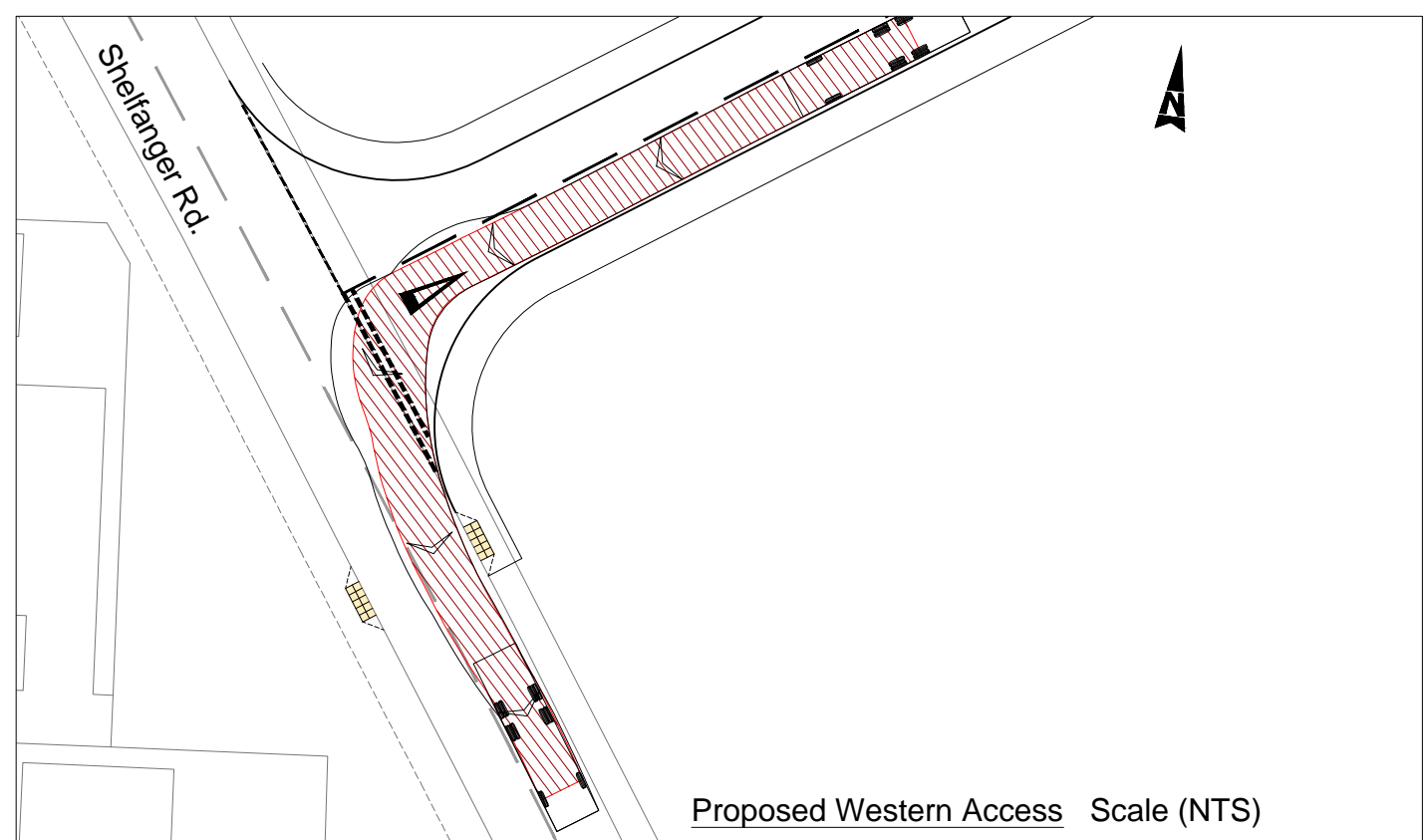
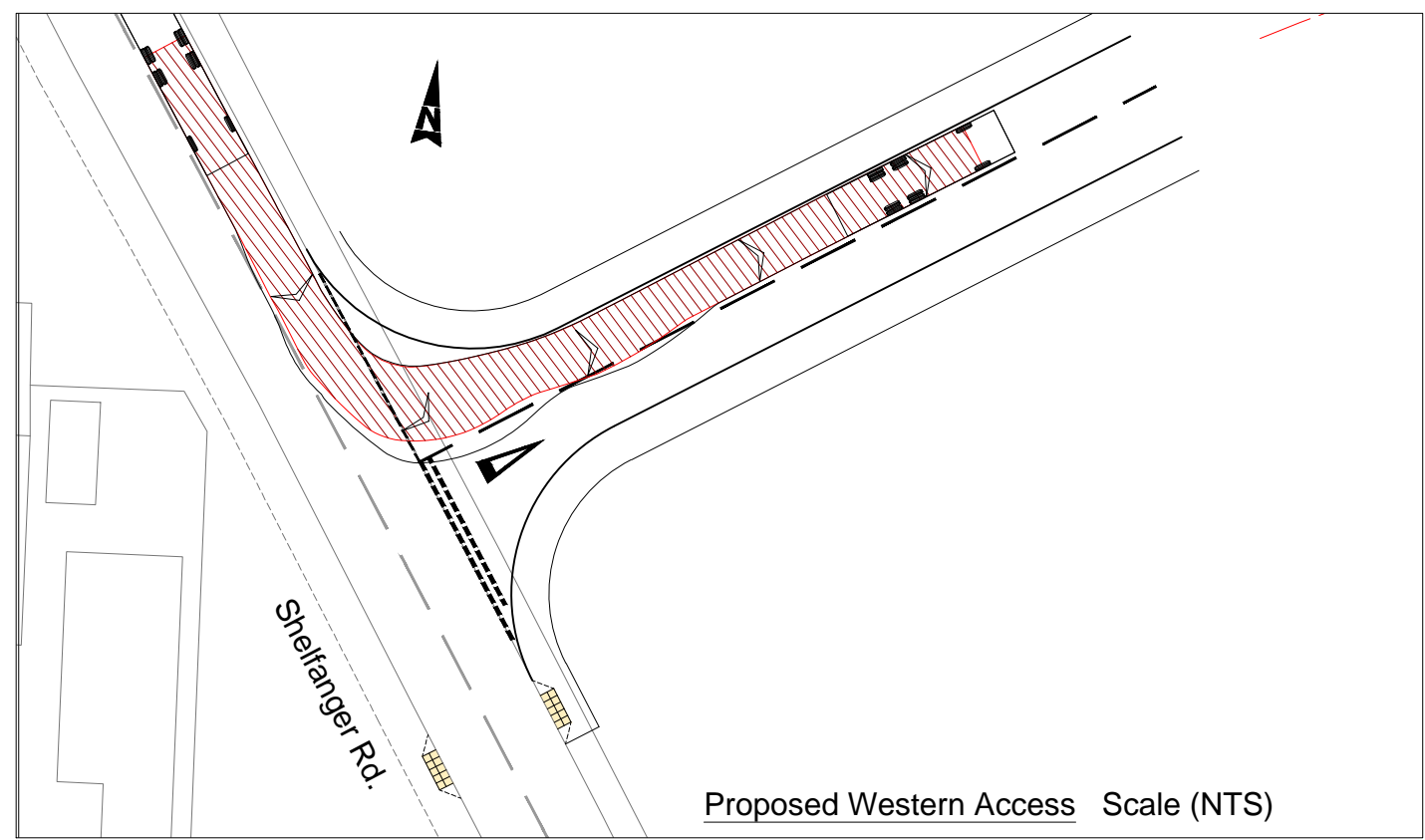

© CROWN COPYRIGHT. ALL RIGHTS RESERVED
Licence No. AL1000 18595

Key:

Vulture 2225 (with Mercedes Econic 2628LL 6x4 chassis)

Overall Length 9.930m
Overall Width 2.490m
Overall Body Height 3.749m
Min Body Ground Clearance 0.302m
Track Width 2.490m
Lock to lock time 4.00s
Wall to Wall Turning Radius 9.100m

- Notes:**
1. Preliminary design only - based on Ordnance Survey data.
 2. Vehicle Swept Path Analysis based on the provisions of CD123.
 3. Vehicle swept paths shown on this drawing equate to the worst case design vehicle which is expected to use the priority junctions.

SAFETY, HEALTH AND ENVIRONMENTAL INFORMATION					
In addition to the hazards/risks normally associated with the types of work detailed on this drawing, note the following:					
CONSTRUCTION					
NONE					
MAINTENANCE/CLEANING					
NONE					
DECOMMISSIONING/DEMOLITION					
NONE					
It is assumed that all works will be carried out by a competent contractor working, where appropriate, to an approved method statement					
Rev.	Date	Description	By	Chkd	App'd
P1	05.04.20	DRAWING CREATED	AE	PDE	

Drawing Status: **FOR INFORMATION**

ATKINS

5 Wellbrook Court
Girton Road
Cambridge
Cambridgeshire
CB3 0NA

Tel: +44 (0)1223 276002
Fax: +44 (0)1223 277529
www.atkinsglobal.com

Copyright © Atkins Limited (2020)

Project Title		S2		LAND WEST OF HEYWOOD ROAD. DISS	
Drawing Title					
VEHICLE SWEEP PATH ANALYSIS					
Scale	AS SHOWN	Designed	AE	Drawn	AE
Original Size	A3	Date	05.04.20	Date	05.04.20
Checked	PDE	Date	05.04.20	Authorised	
Drawing Number	HA PIN	Originator	Volume	Checked	Project Ref. No.
DISS	XX	- ATK -	SPA -		
		- DR - D -	0001		
Location	Type	Role	Number	Revision	P1